

Township No 162 N. Range No 32 W. 5th Mer. Minnesota.

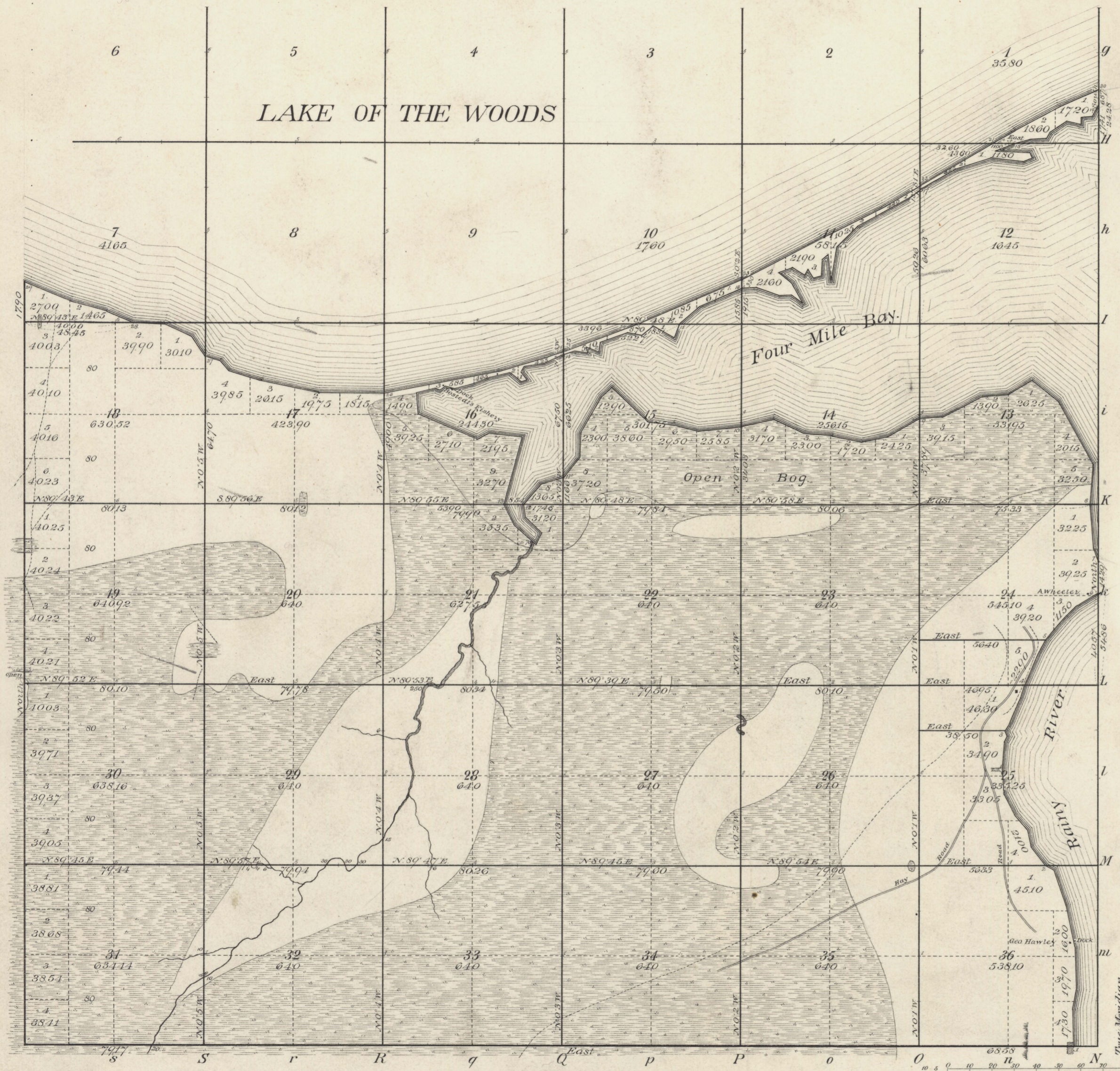

Area of Public Land 133577.4 Acres		of Water Surface		Acres		Total number of Acres	
Surveys designated	By whom surveyed	Date of Contract	Amount of surveys Ch ^s	Lk ^s	When surveyed	Mean declination	
Township lines S & N	Croswell & Smith	Special Instructions April 20 1893			1895	2° 38' E.	
E		December 27 1894	21	10			
Subdivisions of Secs.			1	14	90		
Subdivisions			35	57	38	Commenced Apr. 15 1895 Completed Apr. 29 1895	
Meanders			21	39	15		
Connections							

The above Map of Township No. 162 N. of Range No. 32 W. of the 5th Principal Meridian, Minnesota, is strictly conformable to the field notes of the survey thereof on file in this Office which have been examined & approved.

Surveyor General's Office
St. Paul, July 14th 1896

J. H. Kirwan
Surv^r Genl.